

Madison, Wisconsin

CITY OF MADISON

CITY ENGINEERING DIVISION

DEPARTMENT OF PUBLIC WORKS

PLAN OF PROPOSED IMPROVEMENT

PUBLIC IMPROVEMENT PROJECT APPROVED

SEPTEMBER 3, 2019

BY THE COMMON COUNCIL
OF MADISON, WISCONSIN

PUBLIC IMPROVEMENT DESIGN
APPROVED BY:

 10/10/19
City Engineer Date

DESIGNED BY:

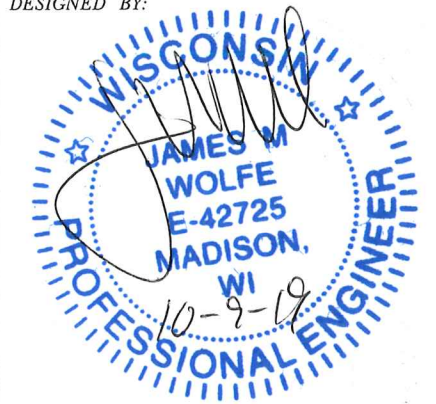

INDEX OF SHEETS

SHEET NO.	TITLE
1	
P1	W. MAIN ST. CAFE PLAN
P2	W. MAIN ST. LANDSCAPING PLAN
P3	E. MIFFLIN ST. CAFE PLAN





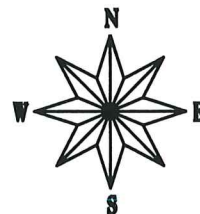

CAPITOL SQUARE CAFE AREAS

CITY PROJECT NO. 11166

CONTRACT NO. 8365

PROJECT
LOCATION

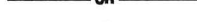

CONVENTIONAL SIGNS	
FIELD VERIFY ALL UTILITY LOCATIONS	
GAS	 G
STORM SEWER	 ST
SANITARY SEWER	 SAN
WATER	 W
OVERHEAD ELECTRIC	 OH
BURIED ELECTRIC	 E
LIGHT POLE	

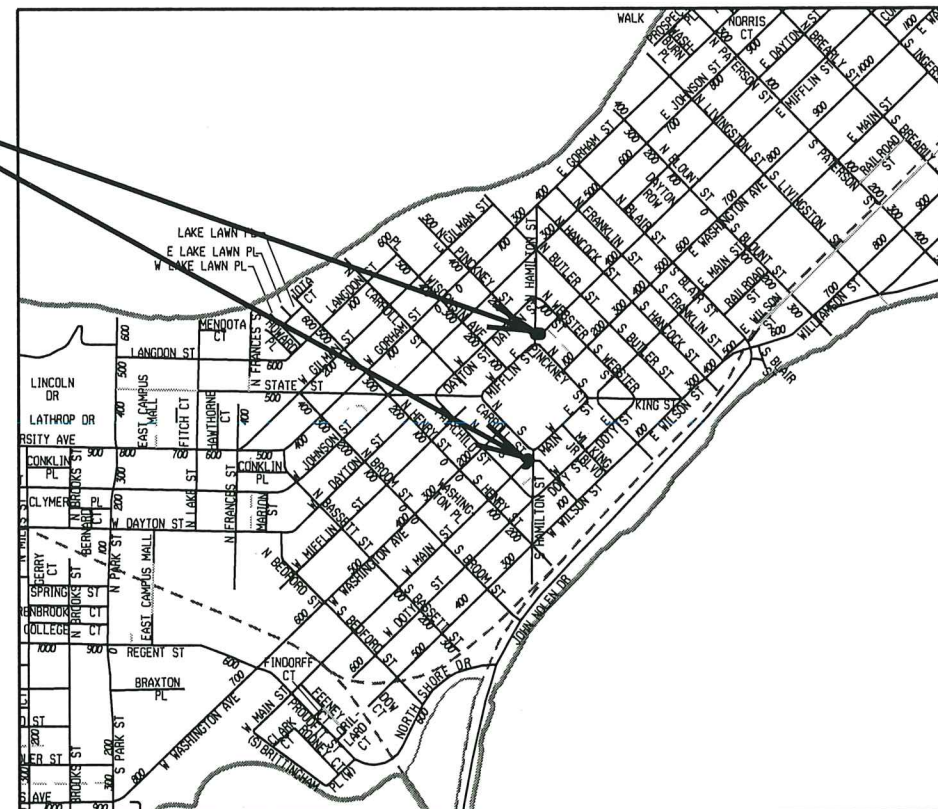

PLOT SCALE: _____

PLOT NAME: _____

REV. DATE: _____

ORIGINATOR: CITY OF MADISON, STREETS DIVISION

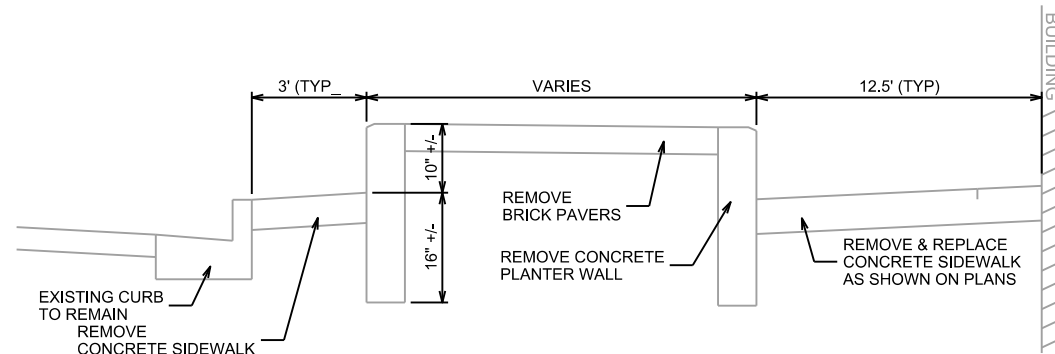

EXISTING SIDEWALK & TERRACE DETAIL

NOT TO SCALE
ALL DIMENSIONS ARE APPROXIMATE

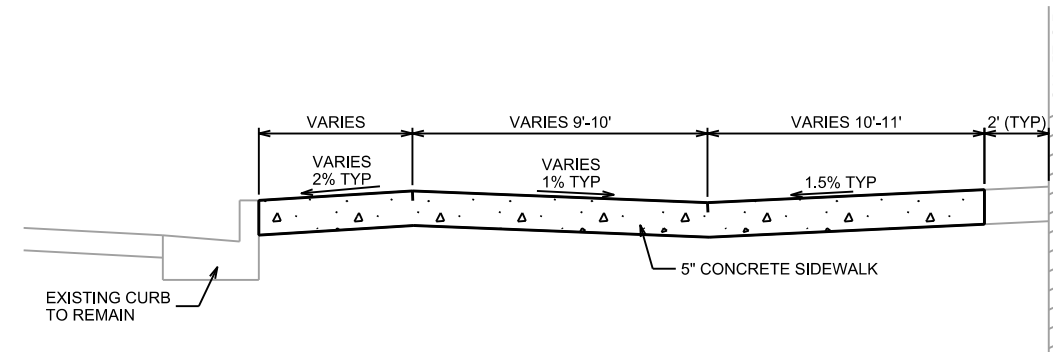

PROPOSED SIDEWALK & TERRACE DETAIL

NOT TO SCALE
ALL DIMENSIONS ARE APPROXIMATE

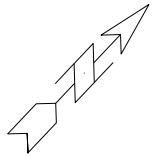

W. MAIN STREET

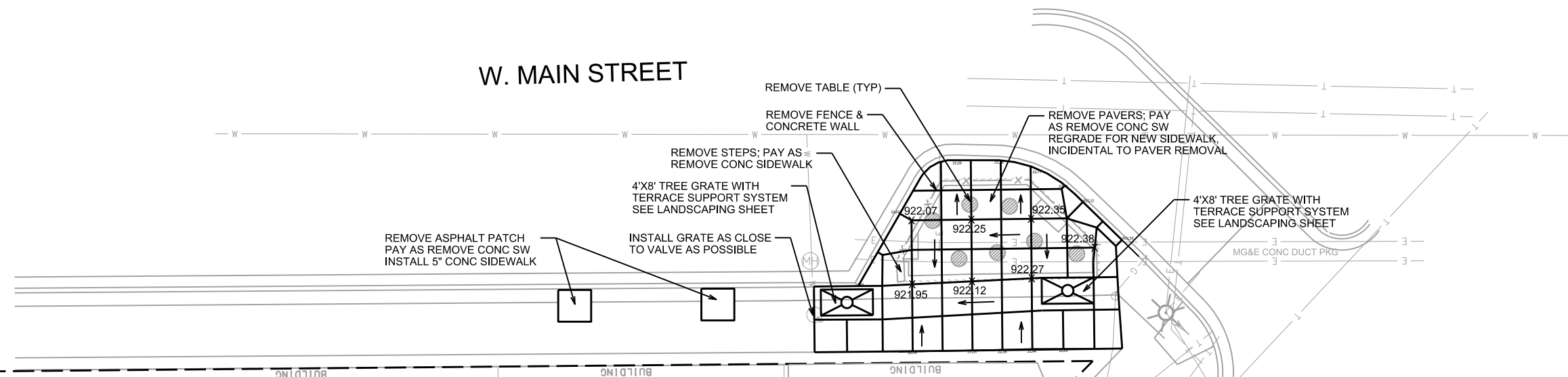

0709-231-1901-4
MUZZEY'S COMPANY LLC
C/O JACK P WILLIAMS
105 W Main St
"GENNA'S"

S HAMILTON STREET

PLOT SCALE: _____

PLOT NAME: _____

REV. DATE: _____

ORIGINATOR: CITY OF MADISON, STREETS DIVISION

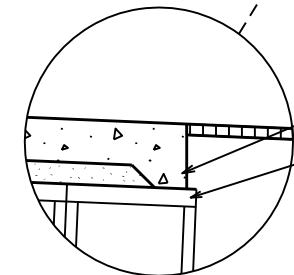
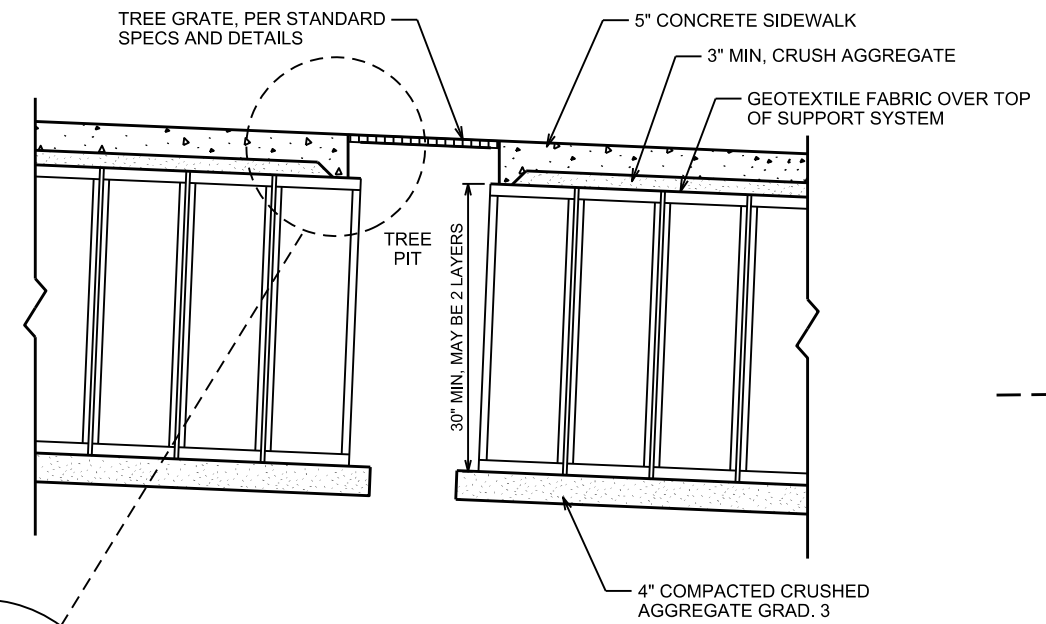

THICKEN CONCRETE EDGE AT TREE GRATE LOCATIONS
SPACING OF CELL AT GRATE LOCATIONS IS DEPENDENT ON MANUFACTURER AND FINAL LAYOUT, TO BE DETERMINED BY CONTRACTOR

TERRACE SUPPORT SYSTEM PROFILE VIEW

NOTES:

1. COORDINATE WITH CITY FORESTRY ON FINAL TREE LOCATIONS AND PLANTING. CONTACT BRAD HOFMANN (220-6796) A MINIMUM OF 1 WEEK PRIOR TO STARTING WORK ON TREE PLANTING LOCATIONS. THIS IS REQUIRED FOR ANY WORK ON THE TERRACE SUPPORT SYSTEM, GRATES/CONCRETE WORK, AND/OR TREE PLANTINGS.
2. INSTALL TERRACE SUPPORT SYSTEM PER MANUFACTURER SPECIFICATIONS AND PER THE DETAILS PROVIDED. THE SUPPORT SYSTEM SHALL BE INSTALLED TO A MINIMUM DEPTH OF 30" BELOW THE SIDEWALK & BASE. DEPTH MAY BE ACHIEVED BY INSTALLING A SINGLE LAYER OF SUPPORT CELLS OR STACKED IN 2 LAYERS.
3. ALL PERIMETERS OF THE SUSPENDED PAVEMENT SYSTEM SHALL BE ENCLOSED WITH A GEOGRID AS RECOMMENDED BY THE MANUFACTURER'S SPECIFICATIONS.
4. A MINIMUM 6' GAP, CENTERED ON THE TREE GRATE OPENING, SHALL BE PROVIDED FOR TREE PLANTING. INSTALL 12" DEEP, MINIMUM ROOT BARRIER AROUND TREE PIT PER MANUFACTURER'S SPECIFICATIONS.
5. BACKFILL THE TERRACE SUPPORT SYSTEM WITH ENGINEERED TOPSOIL; ENGINEERED SOIL (PAID SEPARATELY) SHALL REMAIN MINIMALLY COMPACTED. BACKFILL TO THE TOP OF THE CELLS AND TO WITHIN 4" OF THE BOTTOM OF TREE GRATE. ADD SOIL AS NECESSARY DURING THE PLANTING PROCESS.
6. TERRACE SUPPORT SYSTEM SHALL BE A MINIMUM OF 1 FT. OFF THE BACK OF CURB, IN ALL LOCATIONS AND A MINIMUM OF 4 FT. FROM ANY BUILDING. INSTALL 24" MINIMUM ROOT BARRIER ON BUILDING SIDE OF SUPPORT SYSTEM.
7. INSTALL 4'X8' TREE GRATE, PER CITY STANDARD SPECIFICATIONS. TREE GRATE PAID SEPARATELY.

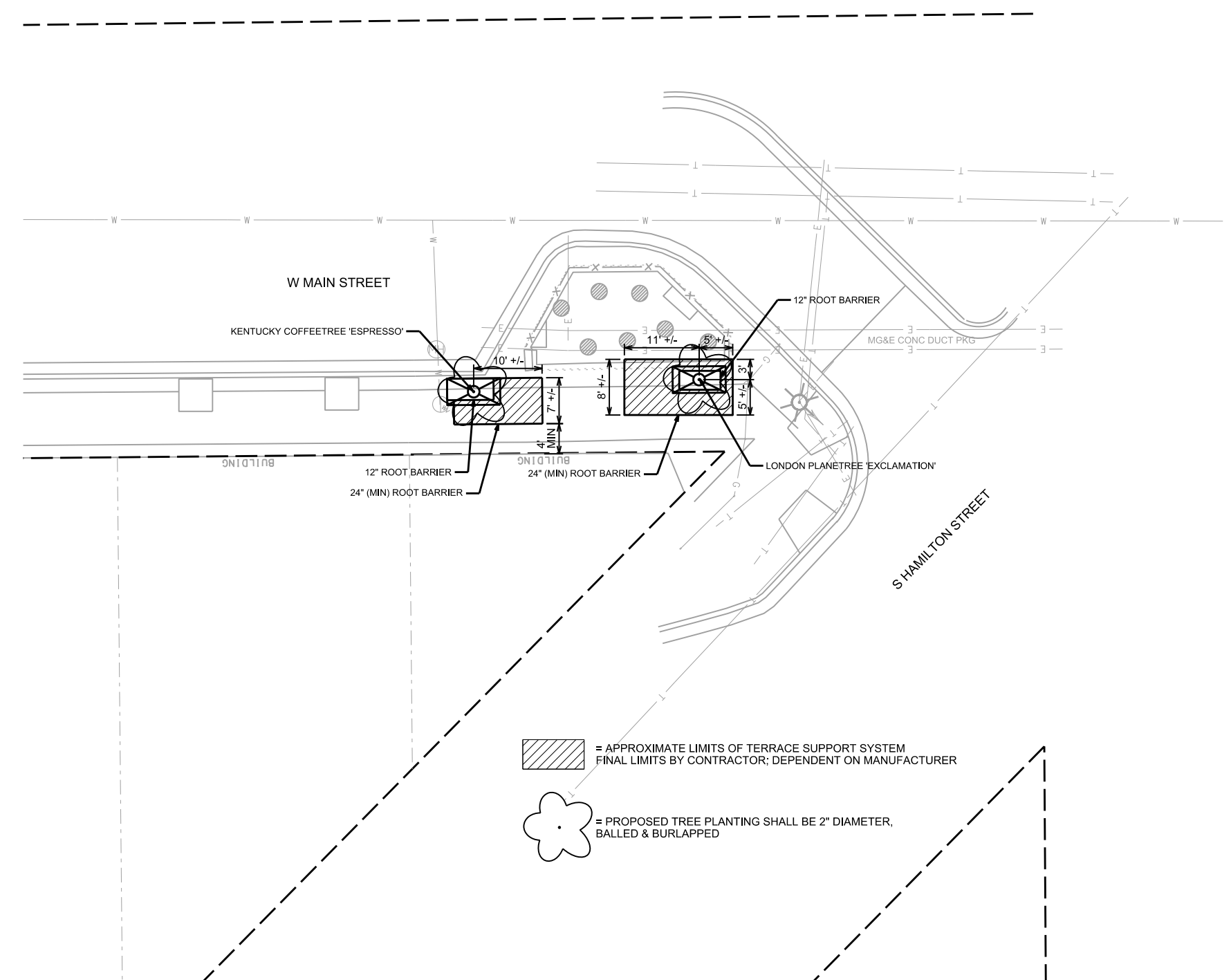

PLOT SCALE: _____

PLOT NAME: _____

REV. DATE: _____

ORIGINATOR: CITY OF MADISON, STREETS DIVISION

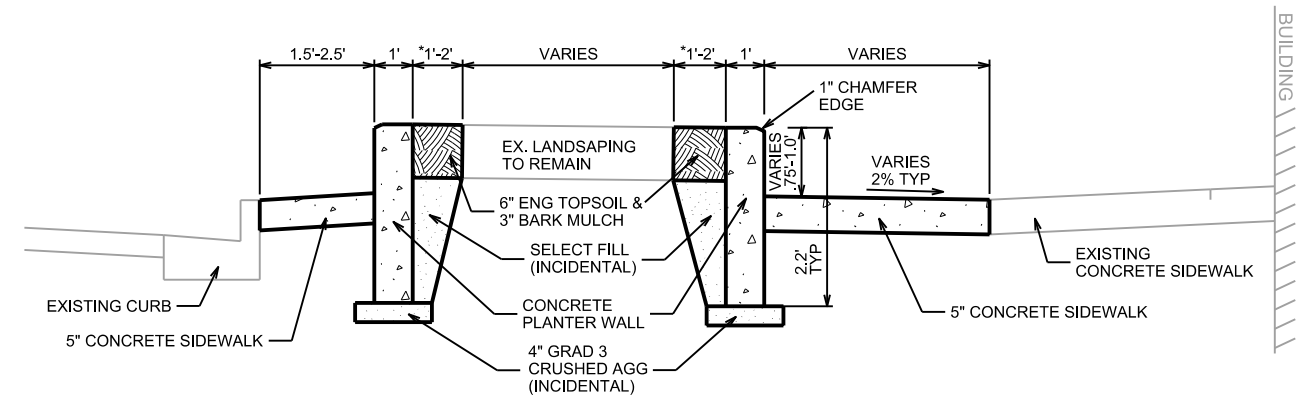

NOTES:
* MINIMIZE EXCAVATED AREA NEAR TREES TO REMAIN

SIDEWALK & PLANTER DETAIL
NOT TO SCALE
ALL DIMENSIONS ARE APPROXIMATE

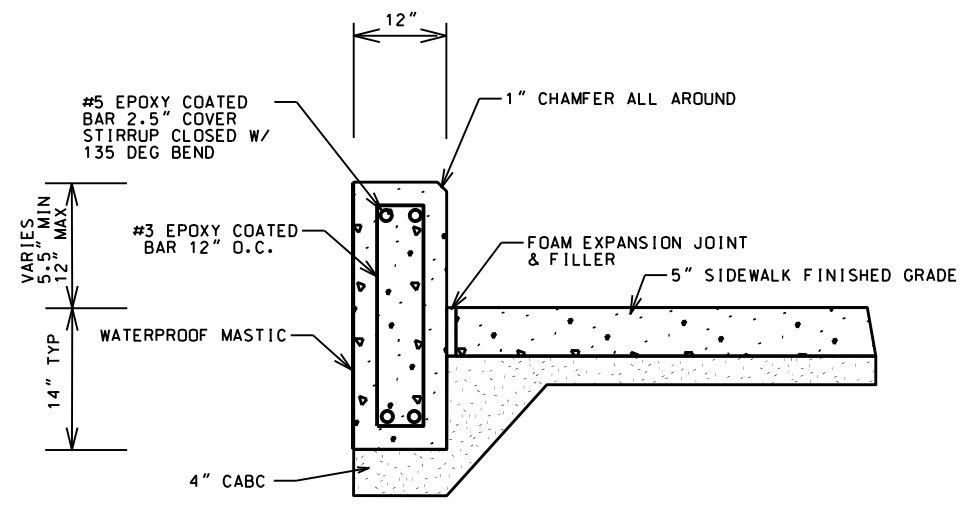

NOTE:
1. ALL EXPANSION AND CONTRACTION JOINTS TO RECEIVE FELT STRIP.
ALL EXPOSED EXPANSION JOINTS TO BE CAULKED.
2. CONCRETE PLANTER WALL INCLUDES ALL REBAR, MASTIC, AND
BASE MATERIAL, AND SELECT FILL FOR BACKFILL.

CONCRETE PLANTER WALL DETAIL

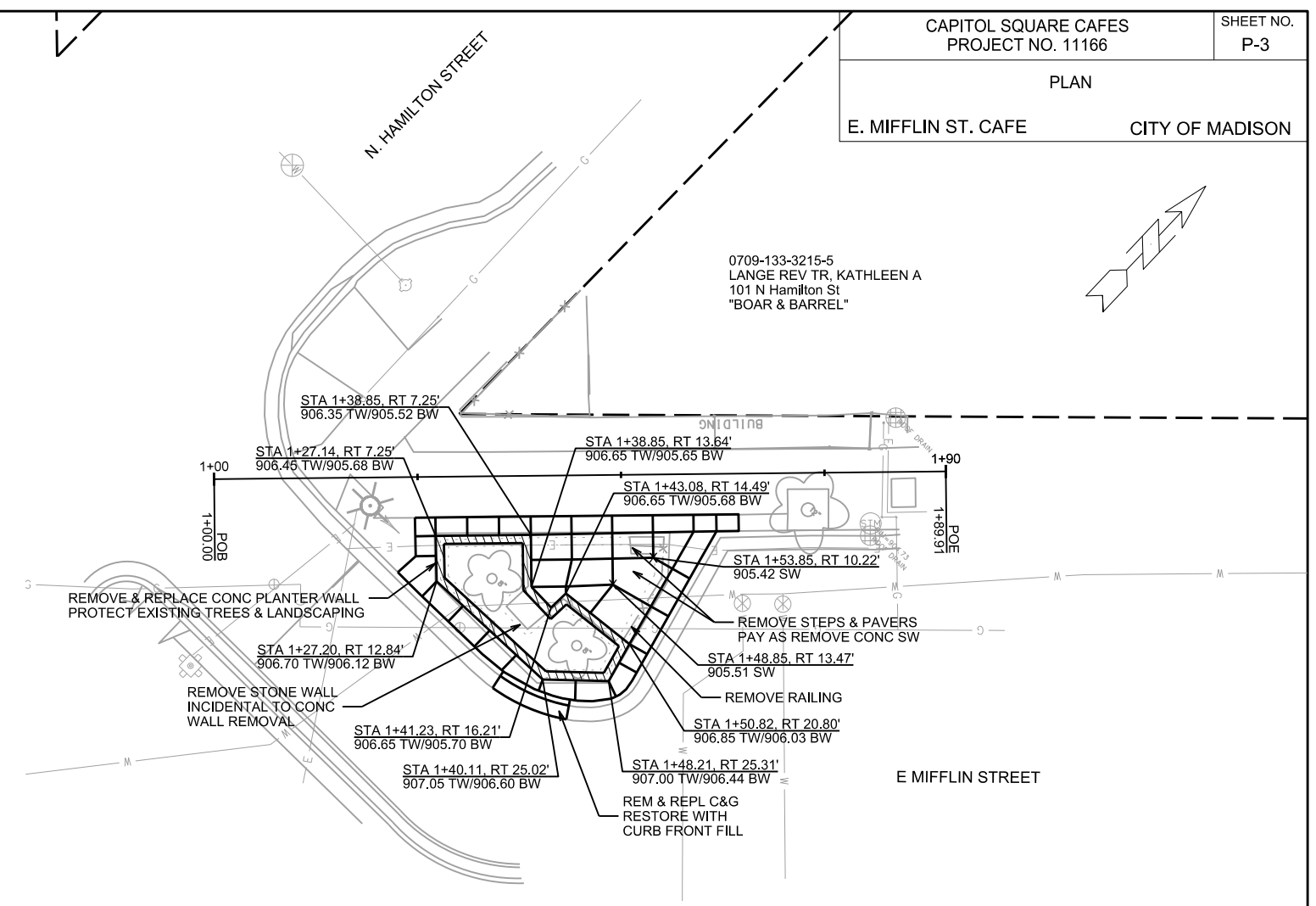

PLOT SCALE: _____

PLOT NAME: _____

REV. DATE: _____

ORIGINATOR: CITY OF MADISON, STREETS DIVISION